

Smutsfilter 5453 Dirtmag

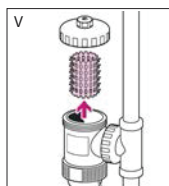

A	Kv	3/4"	10,3	Ø 22	9,5
	(m ³ /h)	1"	10,5	Ø 28	10,6

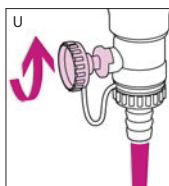
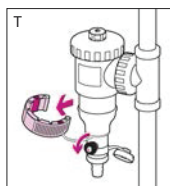
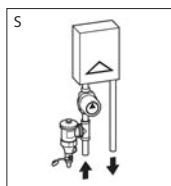
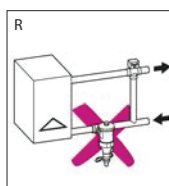
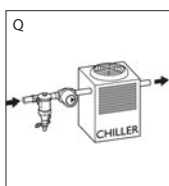
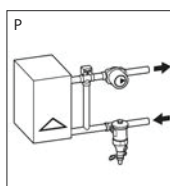
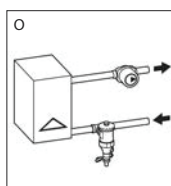
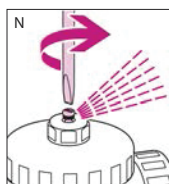
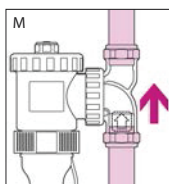
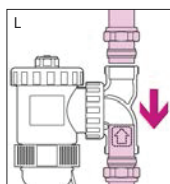
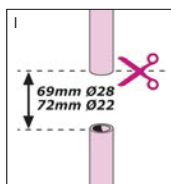
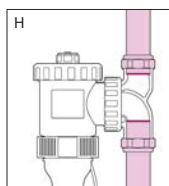
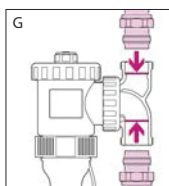
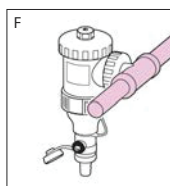
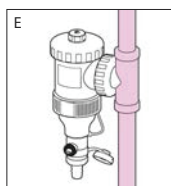
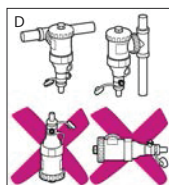
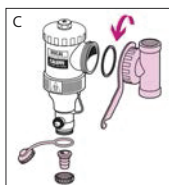

INSTRUCTIONS FOR INSTALLATION, COMMISSIONING AND MAINTENANCE

TECHNOPOLYMER DIRT SEPARATOR WITH MAGNET DIRTMAG

Warnings

The following instructions must be read and understood before installing and maintaining the product. The symbol  means: CAUTION! FAILURE TO FOLLOW THESE INSTRUCTIONS COULD RESULT IN A SAFETY HAZARD!

Safety

The safety instructions provided in the specific document supplied must be observed.

The  symbol on the removable ring indicates that magnets are present, generating a strong magnetic field which could damage any electronic appliances in the vicinity.

LEAVE THIS MANUAL AS A REFERENCE GUIDE FOR THE USER

DISPOSE OF THE PRODUCT IN COMPLIANCE WITH CURRENT LEGISLATION

Function

The dirt separator separates off the impurities contained in air-conditioning systems, collecting them in a large decantation chamber from which they can be discharged while the system is running. The removable magnetic ring captures ferromagnetic impurities. This dirt separator can be installed on both horizontal and vertical pipes.

Medium: water, glycol solutions
 Max. percentage of glycol: 30%
 Max. working pressure: 3 bar
 Working temperature range: 0–90°C
 Ring system magnetic induction: 2 x 0,3 T

Hydraulic characteristics (fig. A)

Dirt separator assembly (fig. B - C)

Assembly and disassembly should always be carried out while the system is cold and not in pressure.

N.B.: use the key supplied in the packaging to fully tighten the side locking nut for the tee fitting.

Installation (fig. D - E - F - G - H - I - L - M - N)

Manually turn the tee fitting to adapt the connections for horizontal or vertical pipes (coupling with position markers) and install in accordance with the flow direction indicated by the arrow on the body.

N.B. (fig. G - H - I - L - M): for 545302 and 545303 versions, insert on the pipes the fittings supplied in the packaging, fully slot the pipes into the tee fitting connections, then tighten the nuts. If retrofitting, cut the pipes as indicated. Fully slot the pipe into the side with the arrow and then into the other side. Tighten the nuts.

Release the air which has built up at the top of the dirt separator body by using a screwdriver to loosen the screw on the top plug (N) and fully re-tighten.

Installation diagrams (fig. O - P - Q - R - S)

Dirt discharge (fig. T - U)

Remove the ring in which the magnets are housed (T) and drain off the impurities, even while the system is running, using the special key provided (U). The drain cock can be adjusted according to the operating requirements.

Maintenance (fig. V)

If necessary, after shutting the pipes off, loosen the top plug using the supplied wrench and extract the internal element for cleaning (V).

Instruktioner på svenska är under konstruktion och kommer inom kort.